

1 COLUMBIA PLACE

SUITE 900

401 WEST A STREET SAN DIEGO CA 92101
 LANDMARK DOWNTOWN
 CLASS A OFFICE BUILDING
 27 STORIES TOTALING 556,750 SF

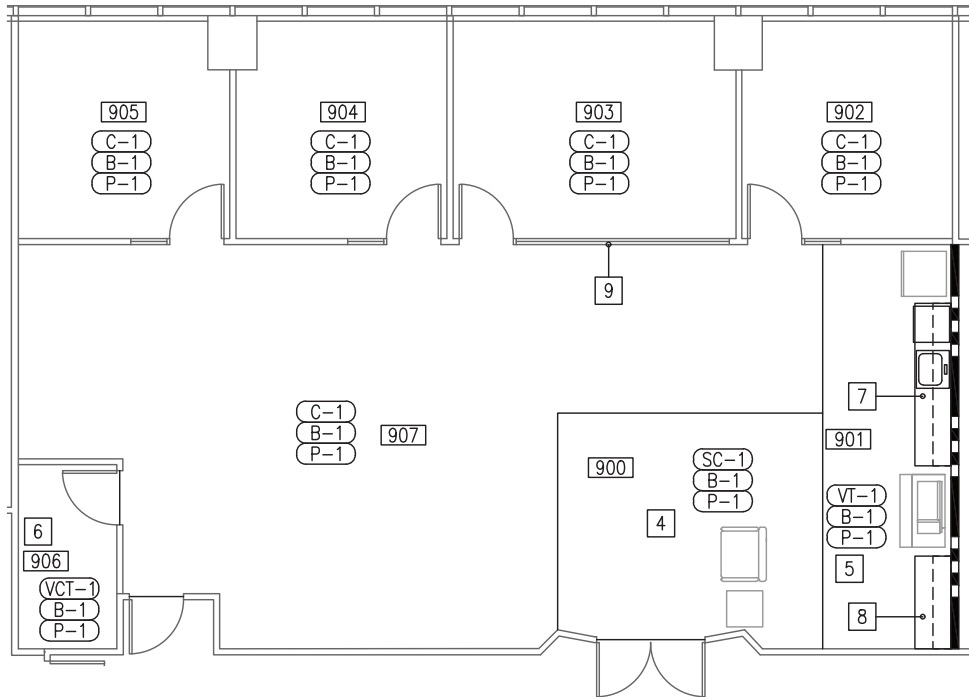

Owned & professionally managed by:



EMMES Leasing
 emmesleasing@eamc.com
 619.515.3400

SUITE	900
RSF	2,240
VIEW	North
STATUS	Vacant
DESCRIPTION	New Spec Suites, Expansive Bay / City Views